

# Dreamy

**Contact us**

**Mailing address**

Add: No 21#, Riwang Road, Qiaotou Park, Cixi City, China

**International trade department**

**Tel:**

From 8:30am-17:30pm (GMT+8)

86-574-63551235

From 18:00pm-23:00 (GMT+8)

86-13506782197

**Fax:**

86-574-63699278

**E-mail:**

[sales@dreamylighting.cn](mailto:sales@dreamylighting.cn)

**Web:**

[www.dreamylighting.cn](http://www.dreamylighting.cn)

# Dreamy

Lighting systems

[www.dreamylighting.cn](http://www.dreamylighting.cn)





## The Company Introduction

Cixi Dreamy Lighting Co.,Ltd is a professional company on the design and manufacture of the outdoor & indoor lights,LED lights ,drivers and the lamp components.

Our company locates in Qiaotou industrial park of Cixi city in Zhejiang province ., It just costs 40 minutes to Ningbo Beilun Port and Ningbo airport, when the Hangzhou Bay Bridge have been finished in May 2008 ,it takes 1.5 hours to Shanghai with very convenient traffic.

### Technical support

The products which are developed and designed by our company,including the power supply,lamps,cables,connectors,drivers and ect,have the international level on the structure ,appearance,quality and safety, the leading prodction have successively got the certifications as TUV,CE, and etc,we help you solve the tough problems. We have the ability to manufacture custom products.

### Quality Policy

At dreamy we care about quality. We passed ISO 9000:2000 registered. We continuously work hard to improve our products and service so that we can keep our customers satified. We have a series of testing equipmment to ensoure the quality meet or exceed the requirements in this field.

Meanwhile, dreamy has warmly will to cooperate with friendly company. We supply the service of OEM, and be willing to be the manufacturing base for global lighting company with our high quality,service and requtation.

Our heritage is providing the highest quality,best performing structured lighting systems dreamy will promote the development of lighting products together with world wide friend. Let our living be convenient and orderliness.





## DRE001-300

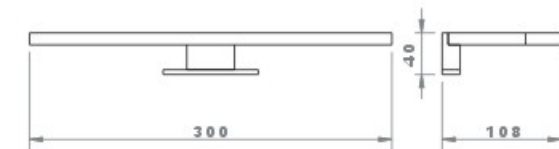
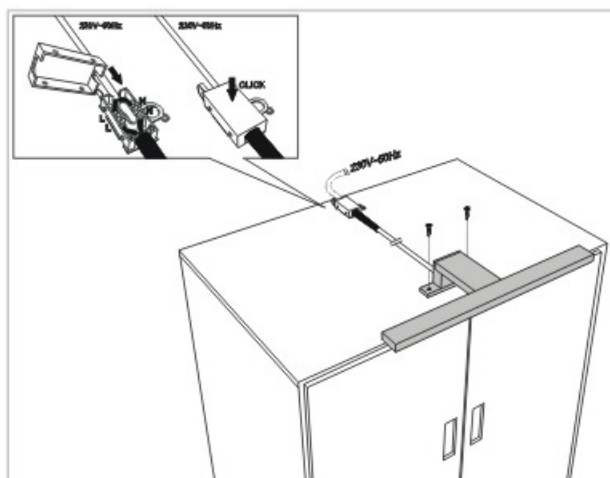

## DRE001-400

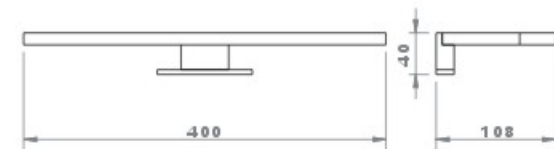
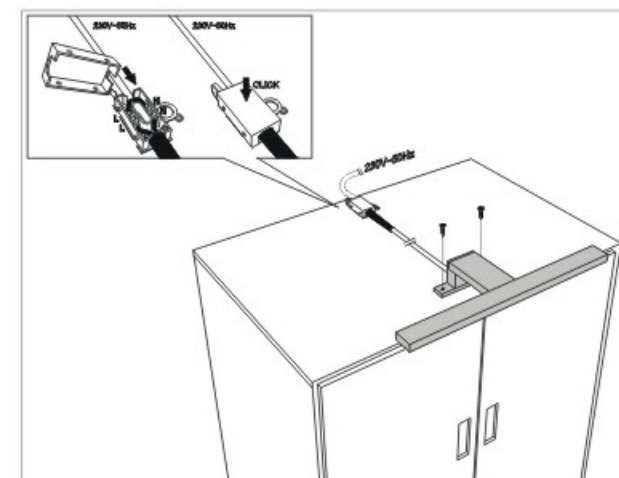

## DRE001-600-S/D

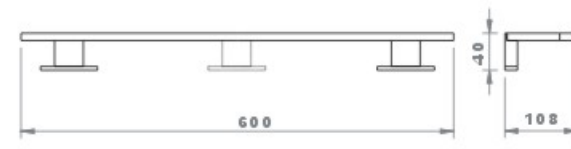
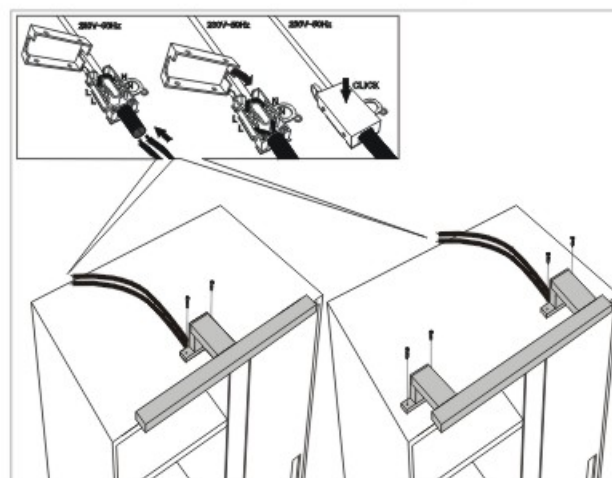

## DRE002-320

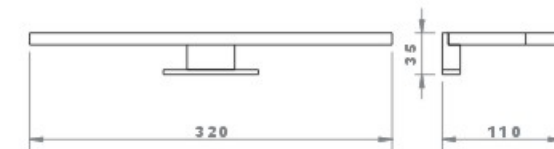
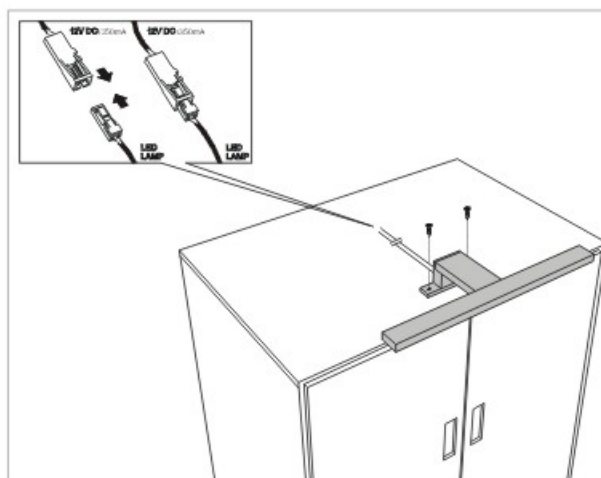

## DRE002-420

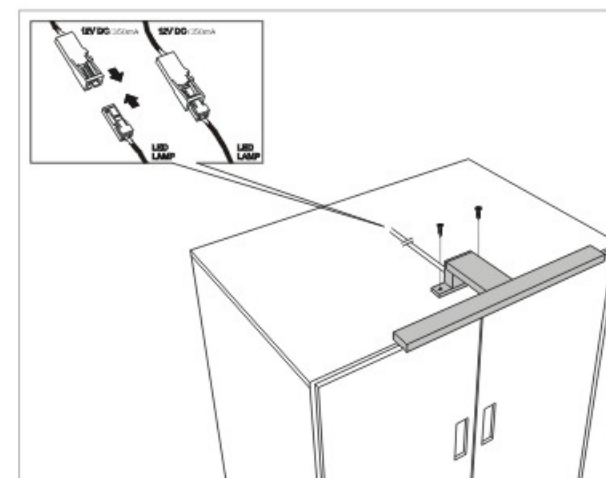
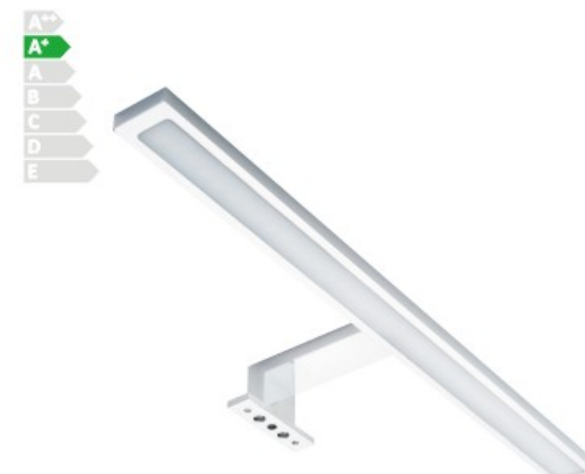

## DRE002-600-S/D

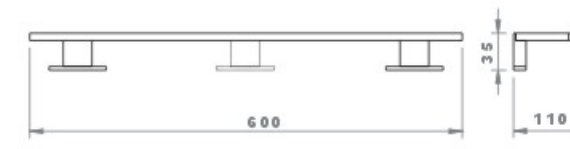
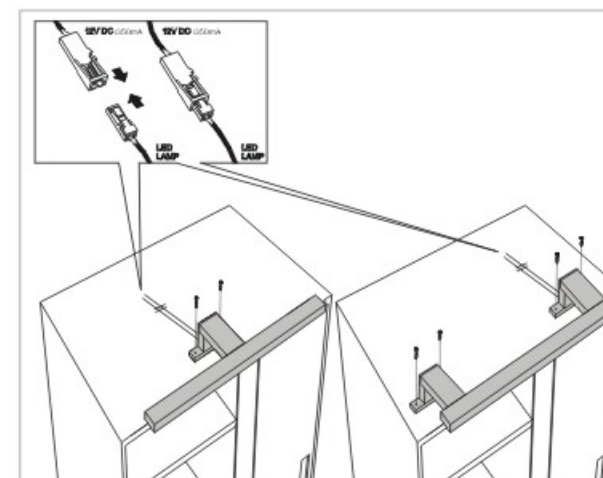

## DRE003-300

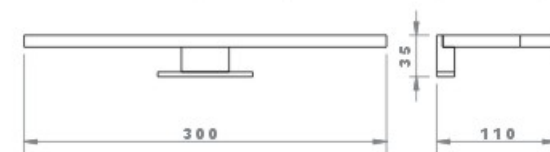
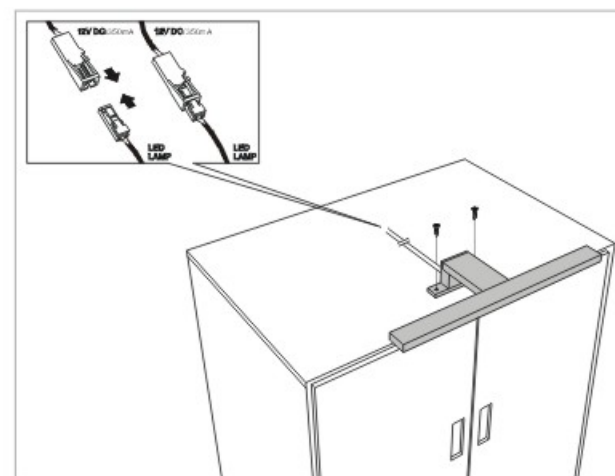

## DRE003-400

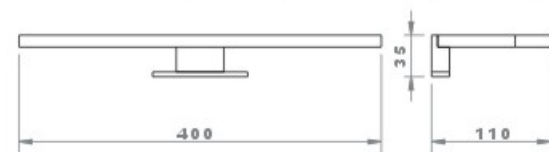
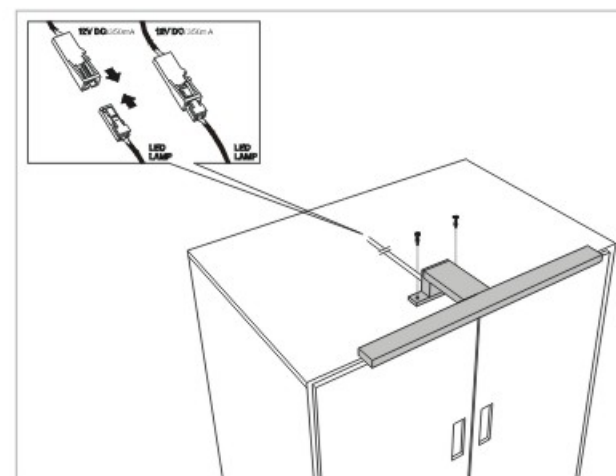

## DRE003-600

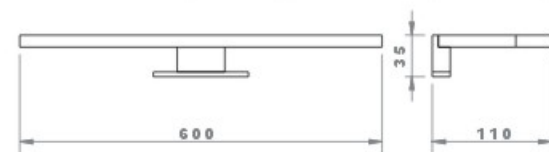
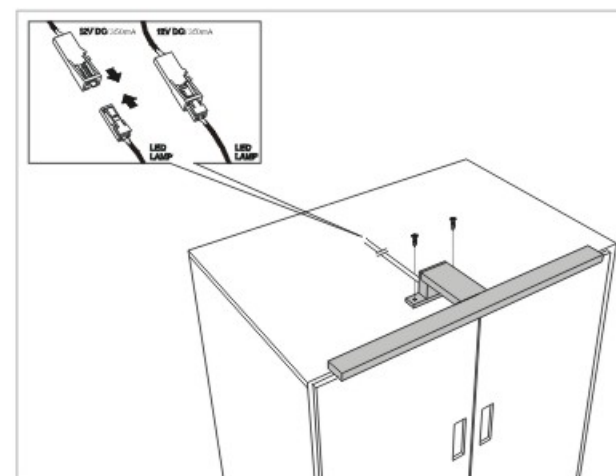

## Installations Accessory for Led mirror light

### Horizontal Installation

Normally, holder A can be installed horizontally on surface, such as the top surface of mirror cabinet and bathroom mirror frame. This holder is to be installed easily. It is the most popular application.

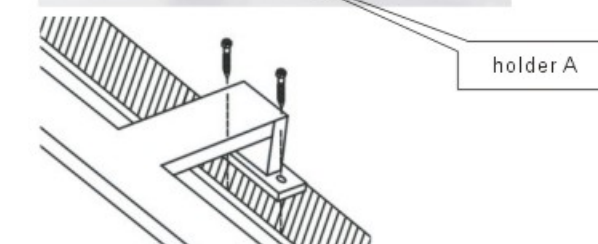

### Wall Installation

Holder B is customized to install on the wall.

Slim and fashion design:

- a. Firstly, the holder can be fixed on the wall with two screws
- B. The light can be fixed on the surface of holder

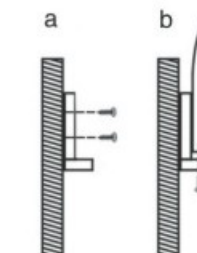

### Clipping Installation

Holder C can be clipped on mirror directly. The holder is fixed by a screw which is in the middle of holder. Convenient installation and demolition.

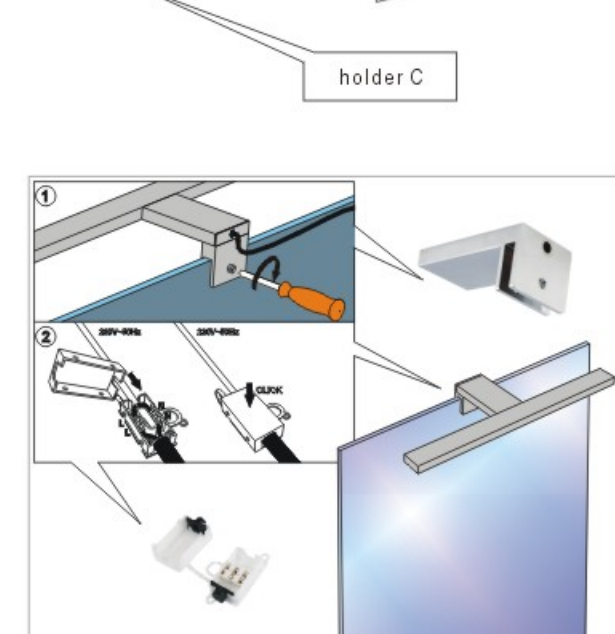
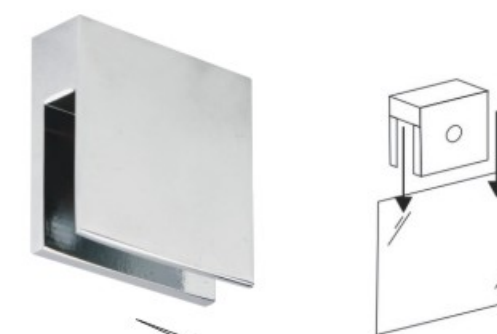



## DRE004

Fixed by soft magnetic stripe(3M sticker) or magnet(screw)

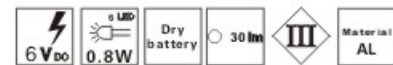
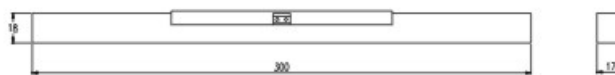
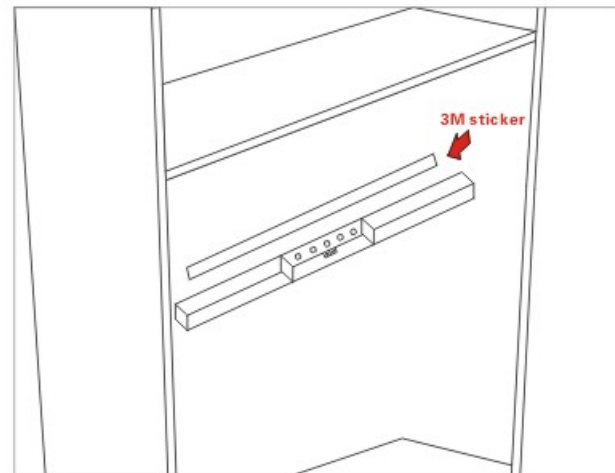

## DRE005

LED Bathroom Lighting Expert

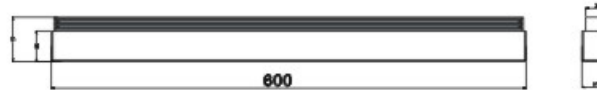

## DRE006

Touch switch for mirror

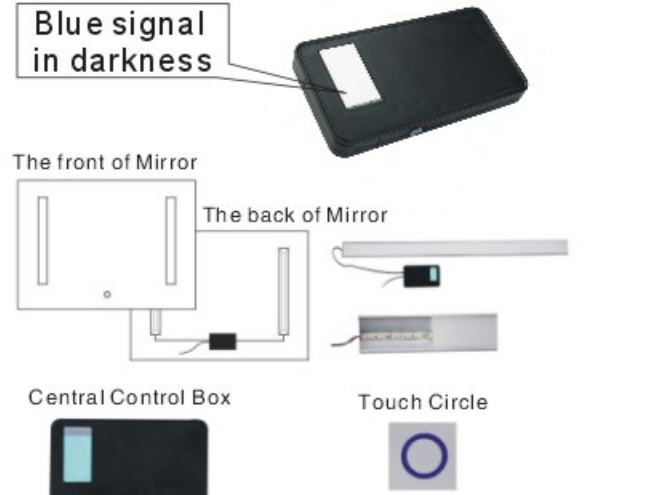

155\*85\*15mm Blue Signal, to be found easily in darkness

This sensor switch is to applied at the back of mirrors. Firstly, one needs to eliminate mercury and form one pattern within the size of 23\*43mm, at one proper position of the mirror. The pattern could be one circle, one switch sign, company's logo, or any other suitable pattern. Secondly, attach the switch at the back of this pattern. After turning on, the switch will emit blue light which goes through the pattern and paint one fluorescent modern blue pattern on the mirror. There are sensor-touch system and driver inside the box. Ip44 certified with excellent safety.

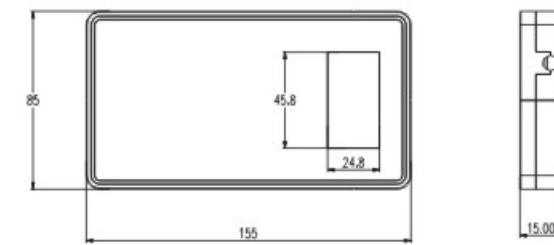

## DRE007

Touch switch for mirror

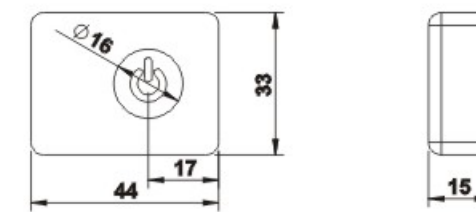
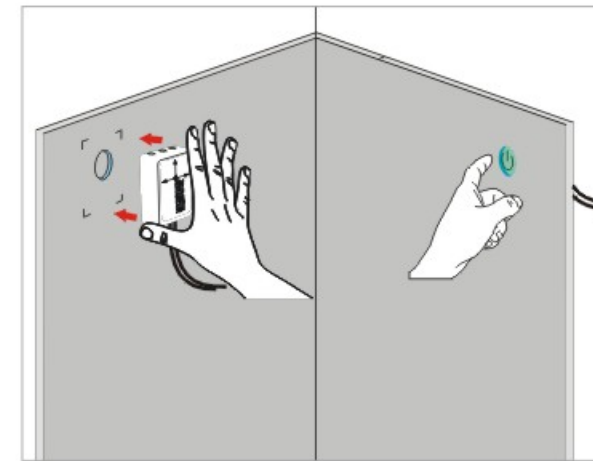
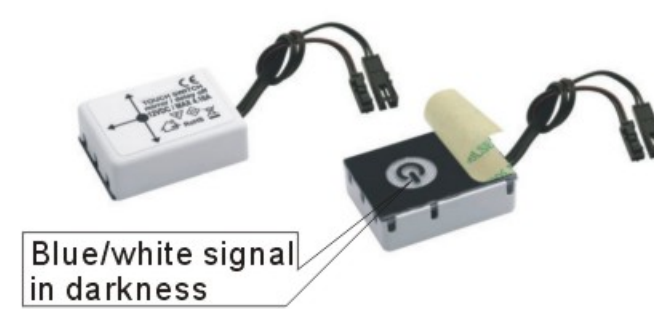

## DRE008

Touch switch for wood

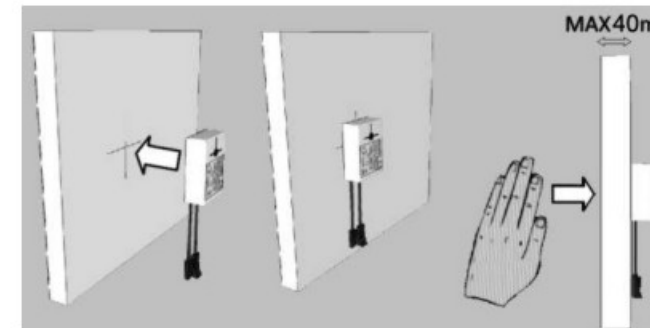
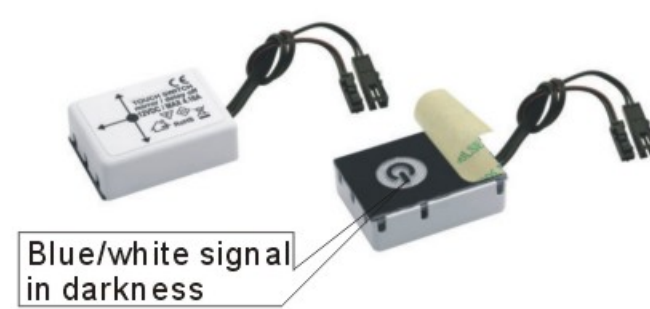

Wood range 30-40mm

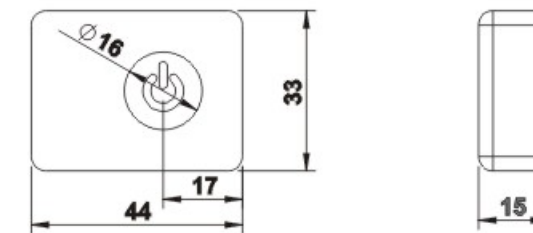

## DRE009

Touch dimmable switch

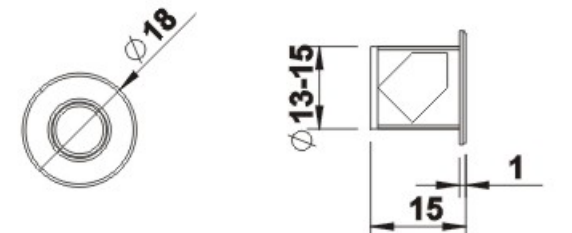
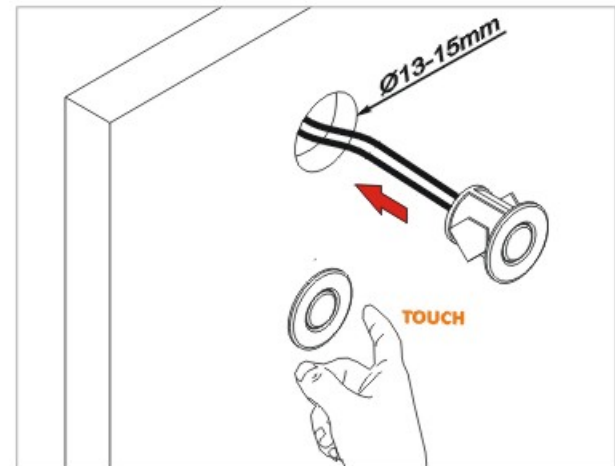

## DRE010

Switch with motion sensor/LED Sensorschalter

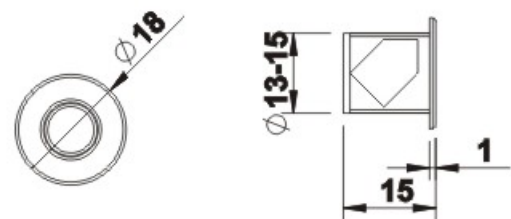
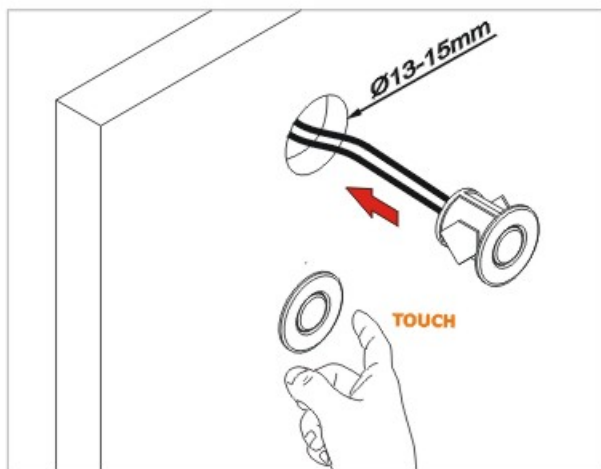

## DRE011

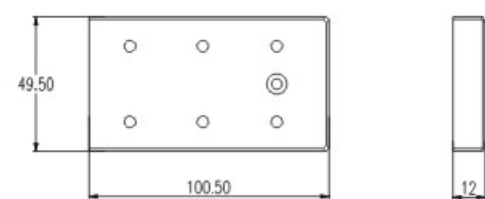
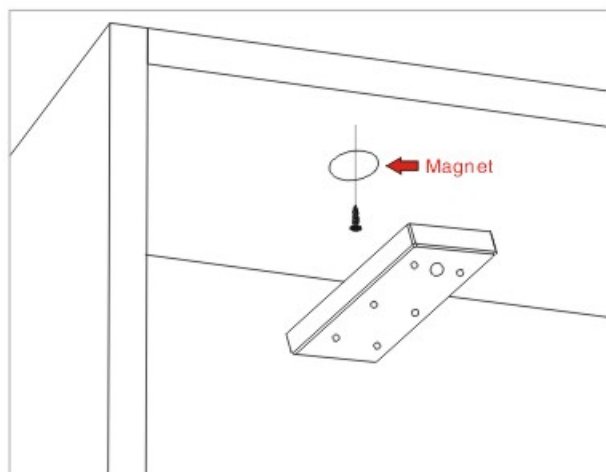
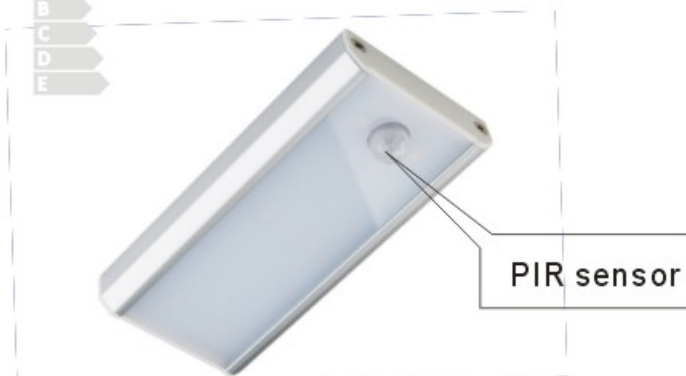

## DRE012

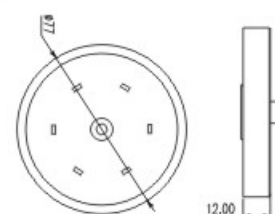
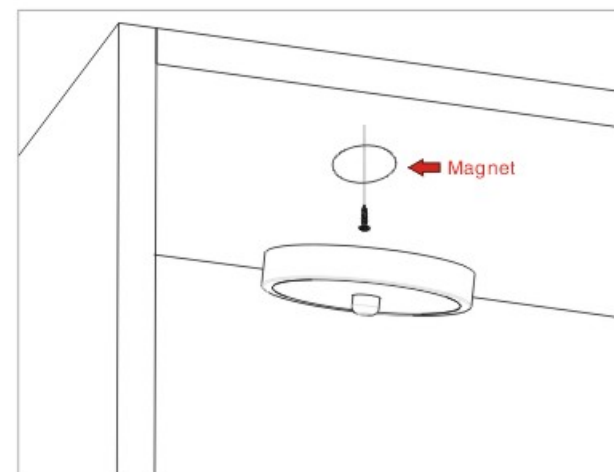

## DRE013

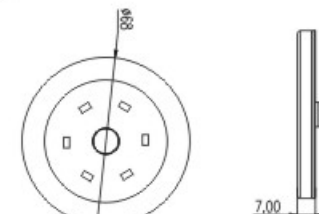
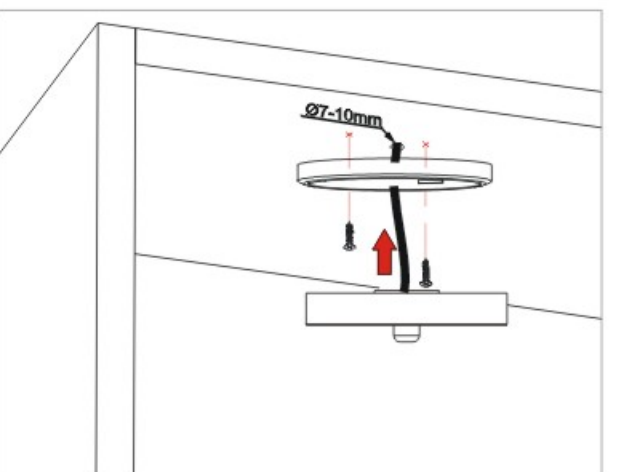
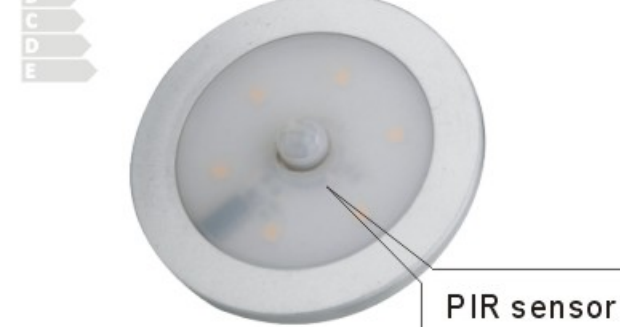

## DRE014

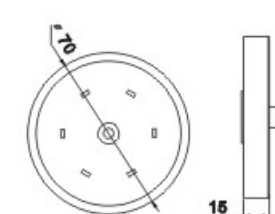
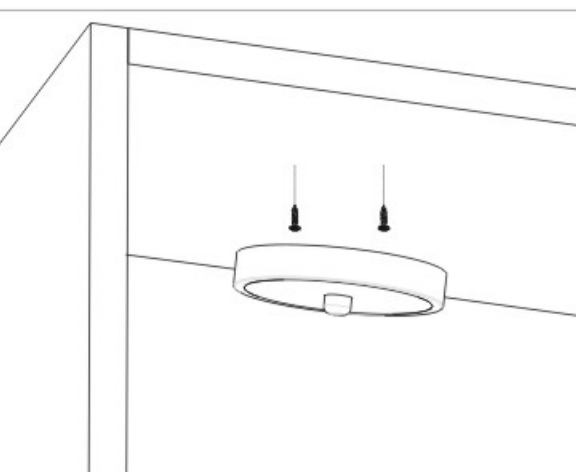

## DRE015



Intelligence Furniture Lighting,  
Which is Worthy of Your Possession  
With Infrared Door Sensor

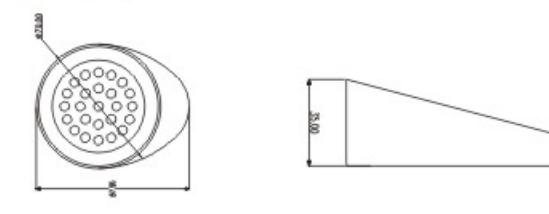
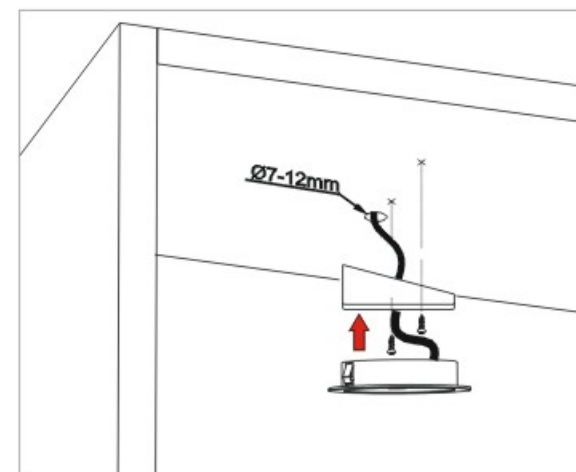



# DRE016

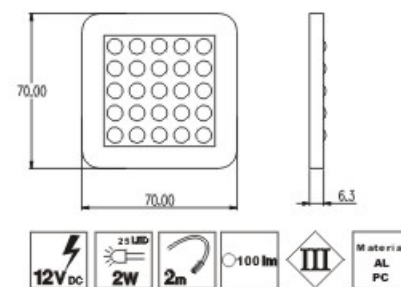
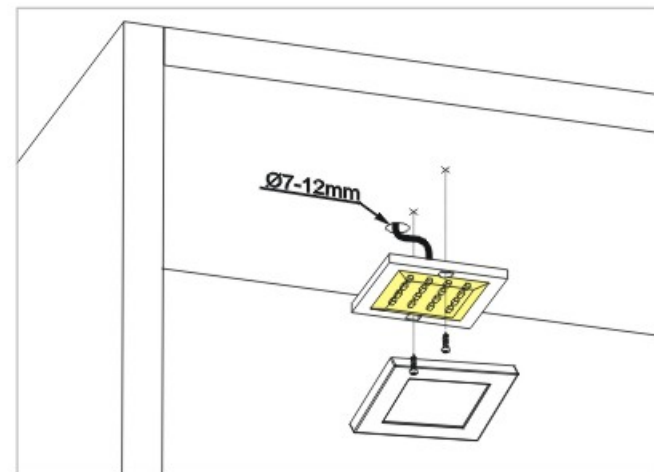

# DRE017

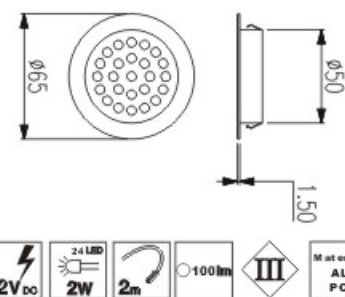
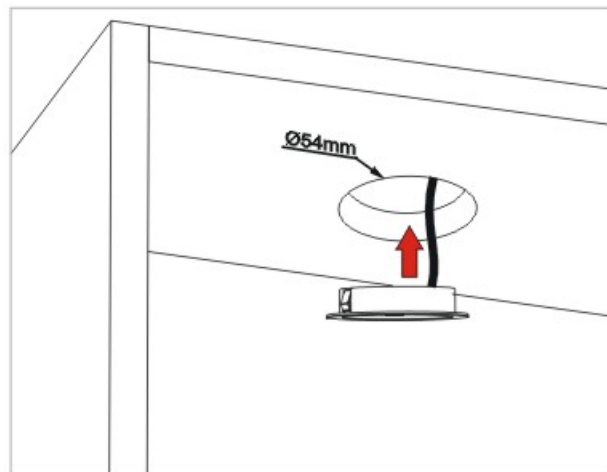

# DRE018

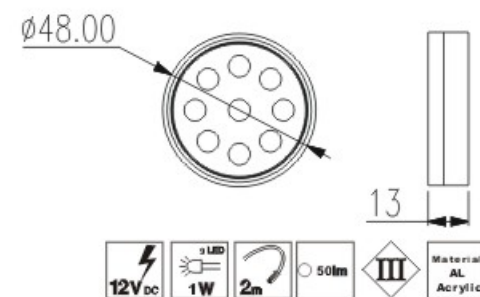
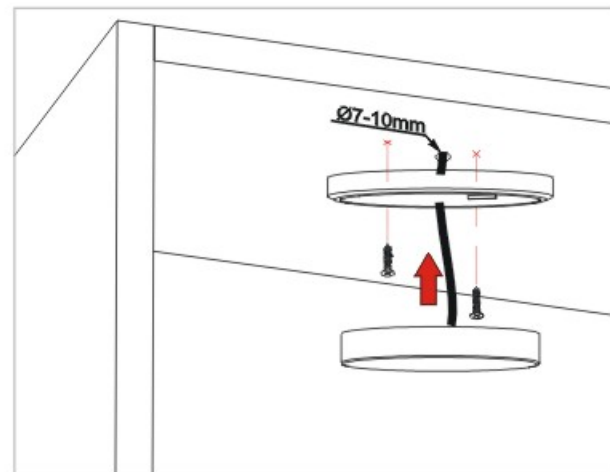

# DRE019

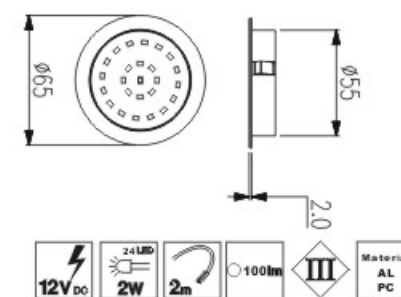
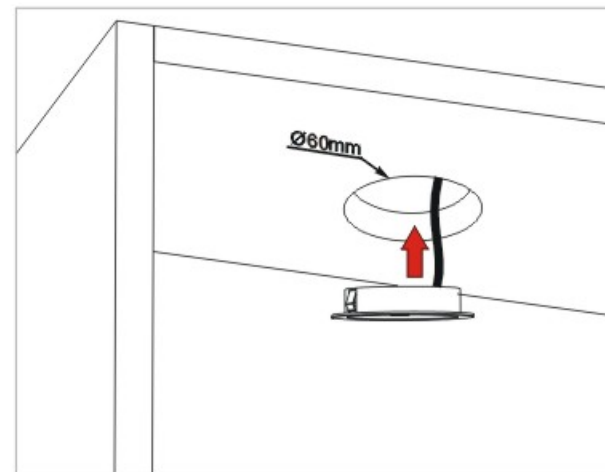

# DRE020



touch switch

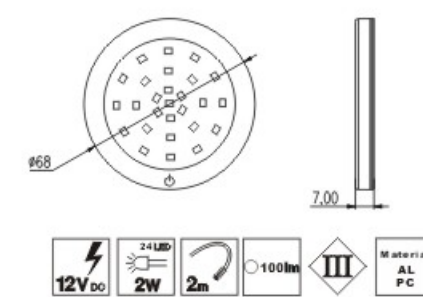
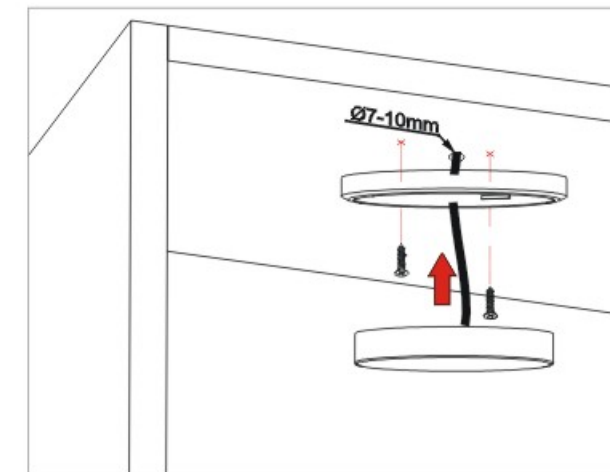

# DRE021

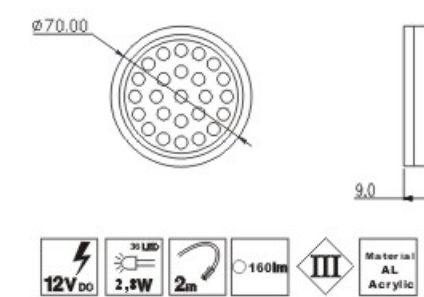
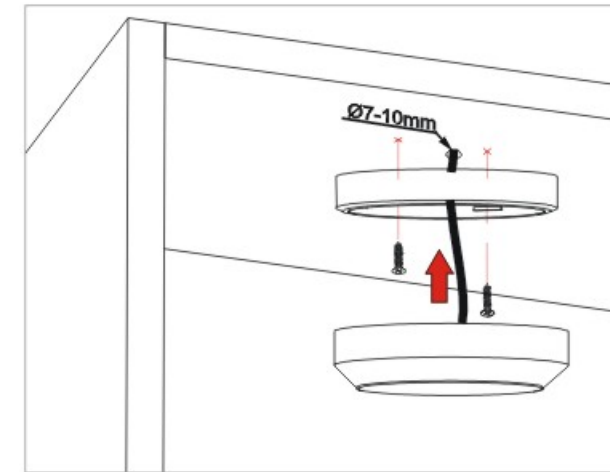

# DRE022

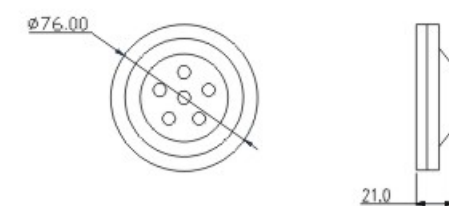
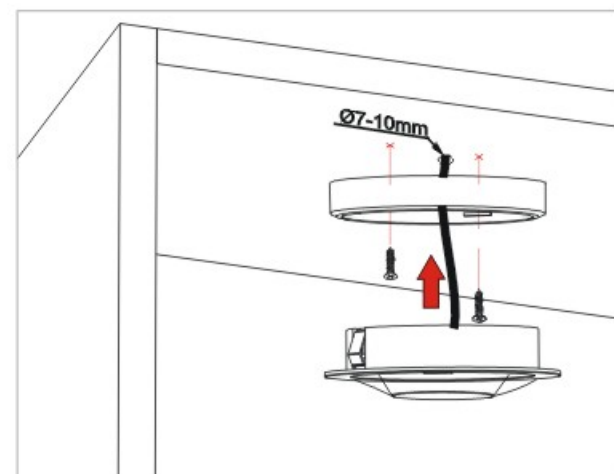

# DRE023

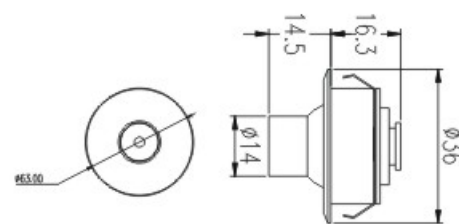
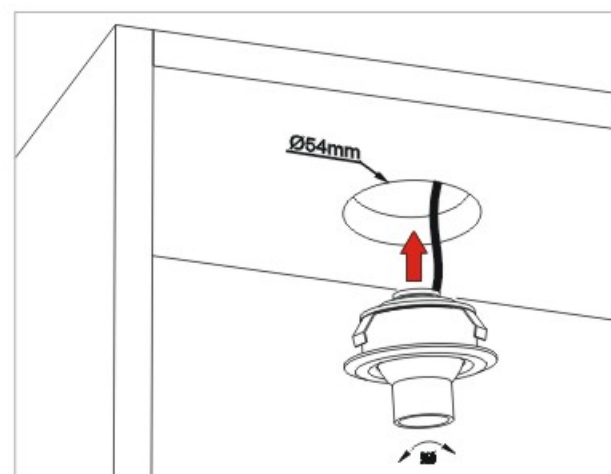
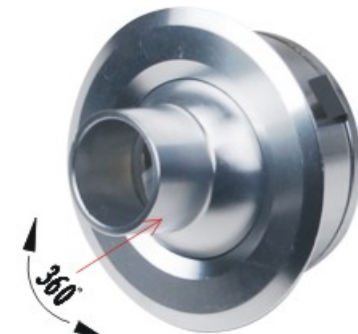

# DRE024

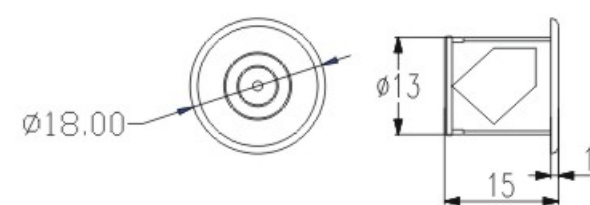
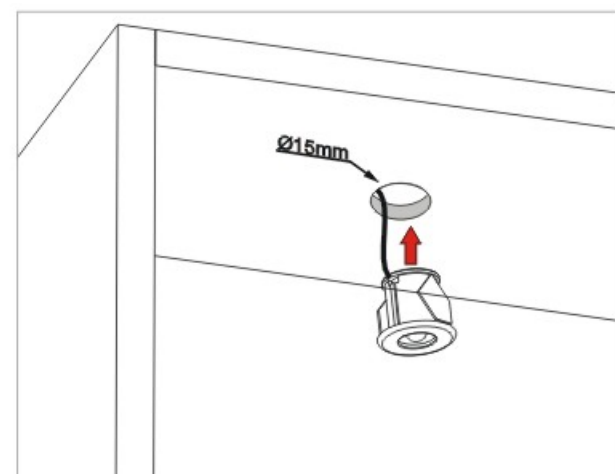

# DRE025

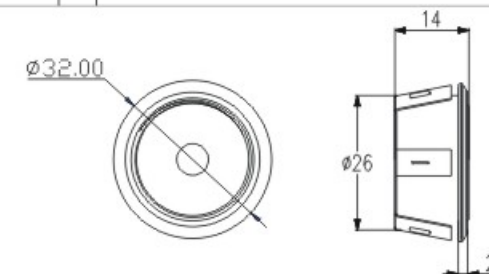
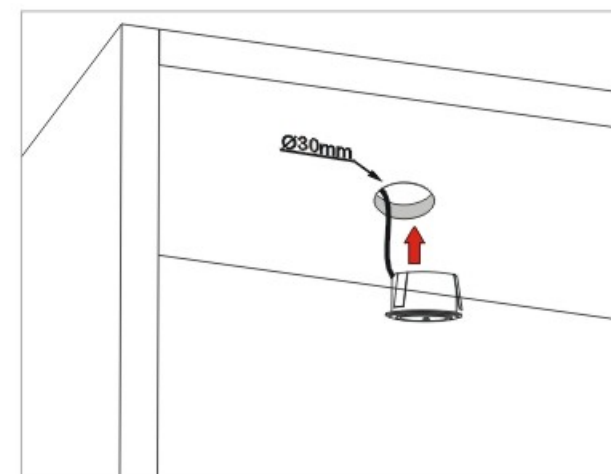

# DRE026

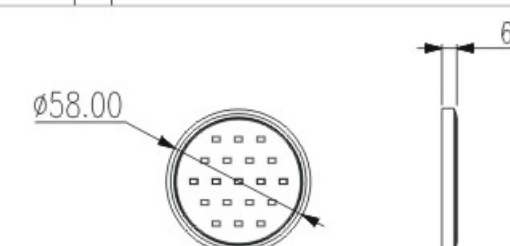
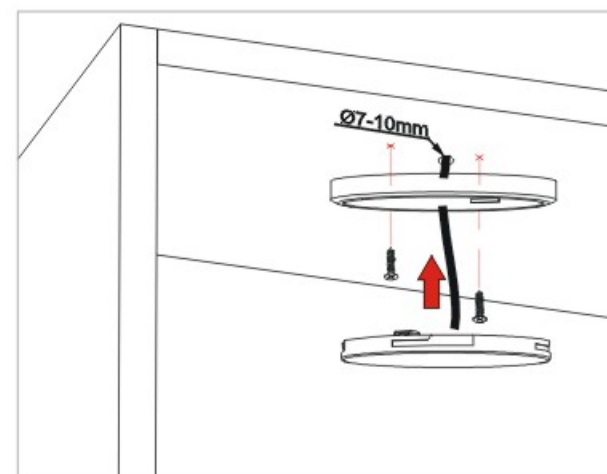

# DRE027

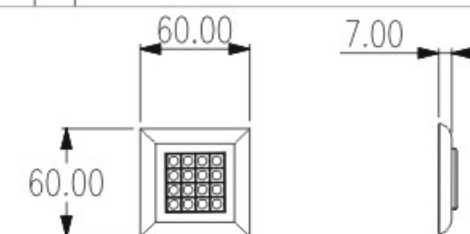
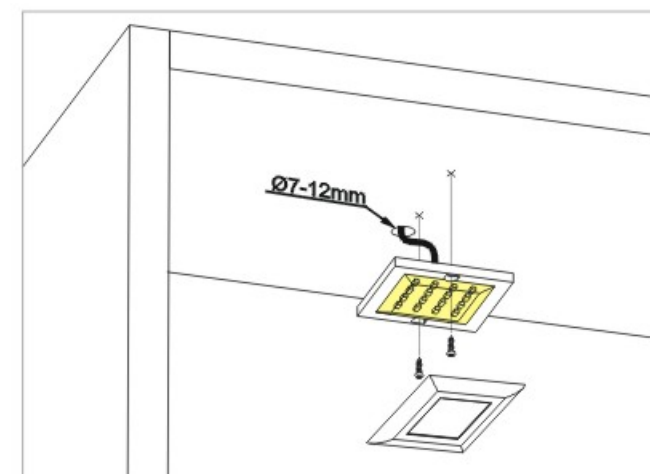



## DRE028

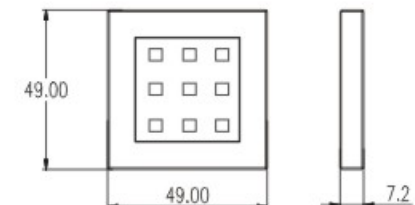
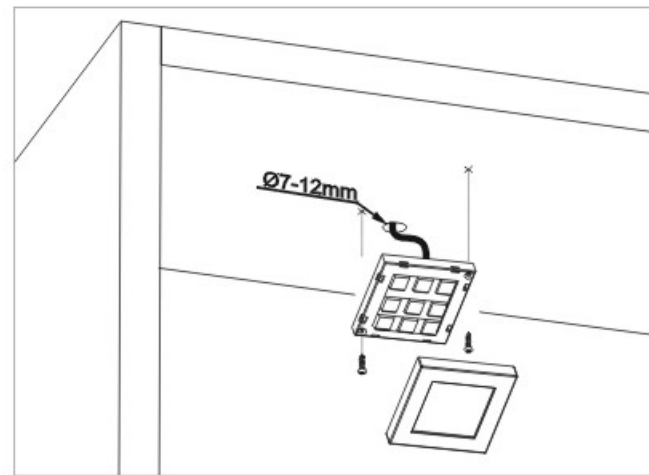

## DRE029

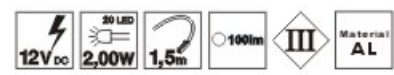
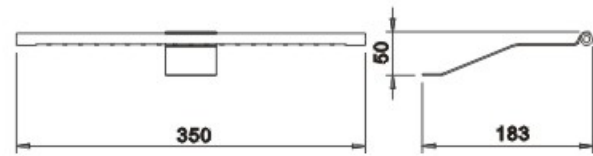
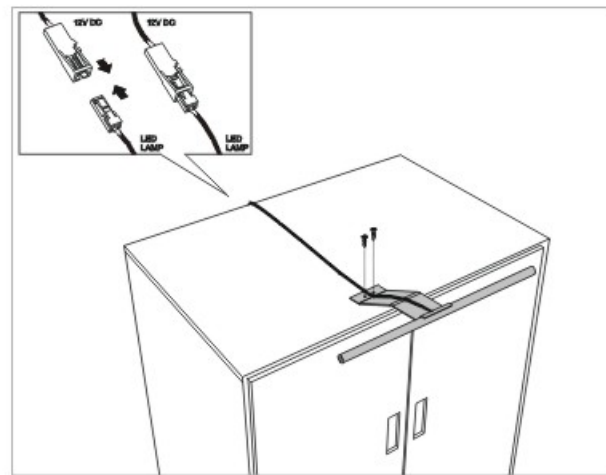

## DRE030

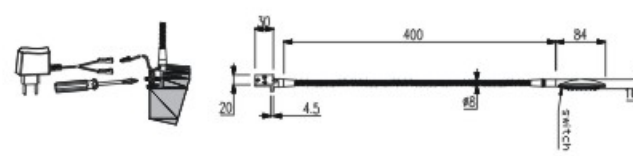
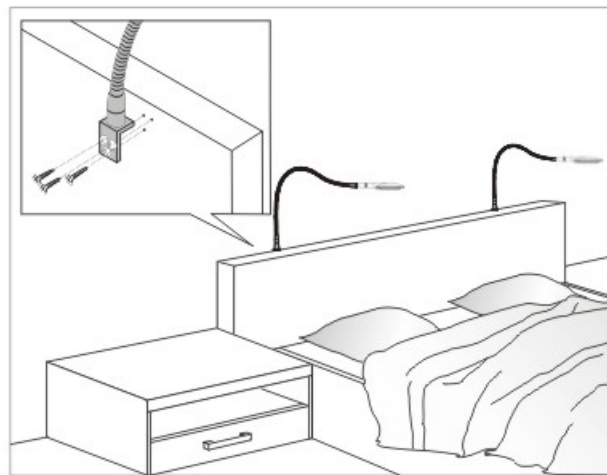

## DRE031

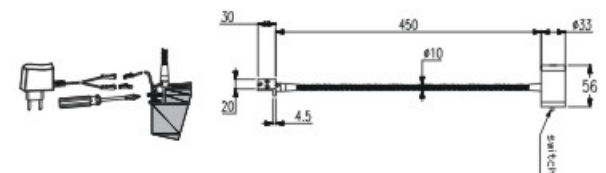
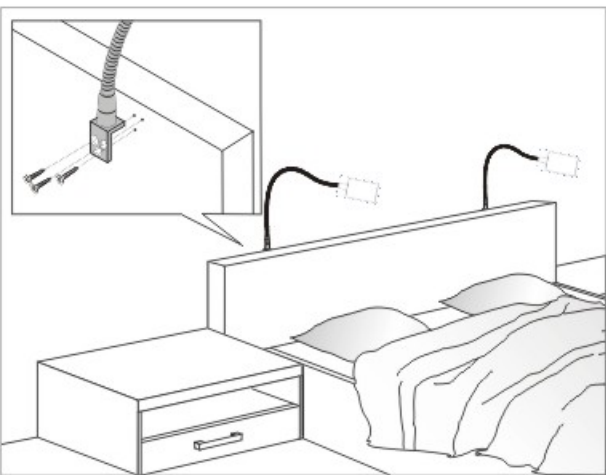

## DRE032

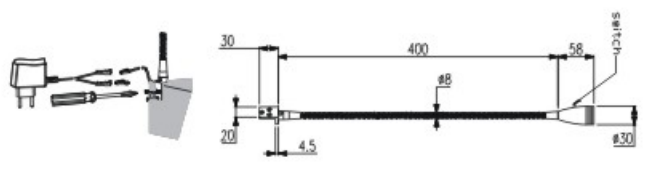
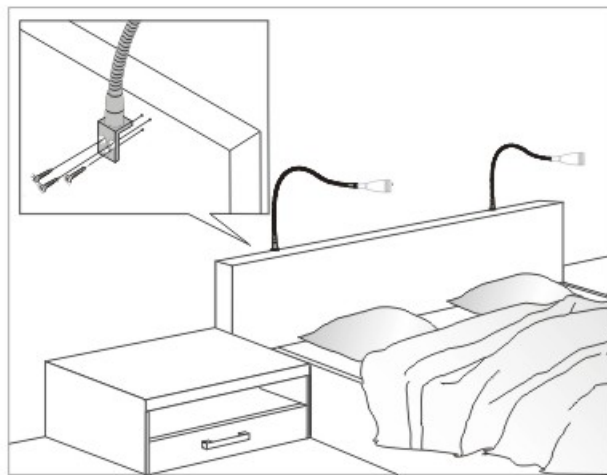

## DRE033

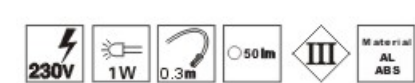
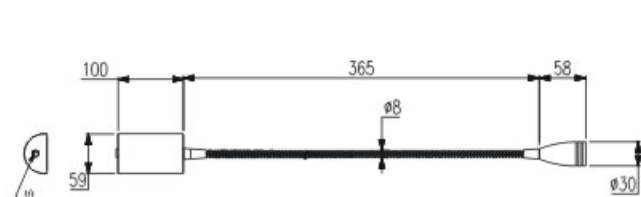
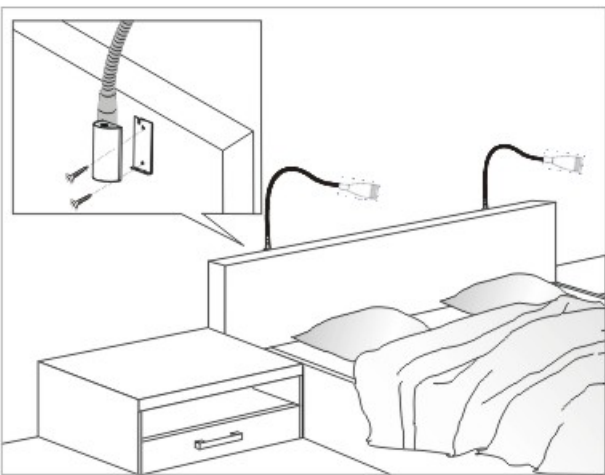

# DRE034

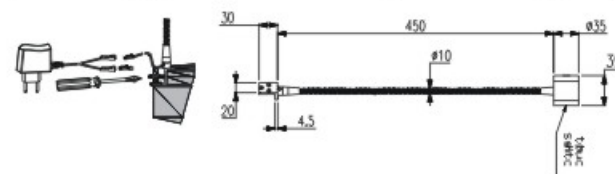
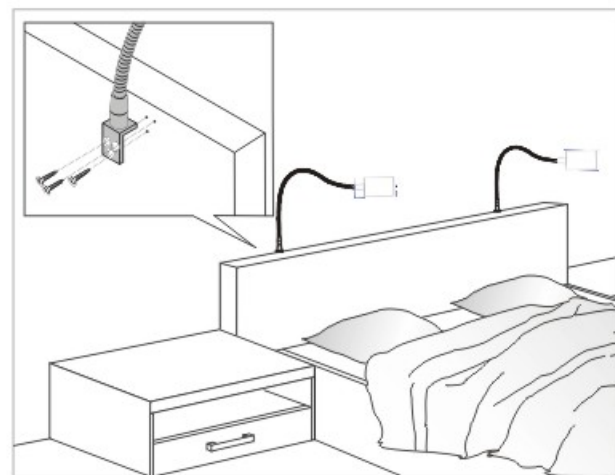

# DRE035

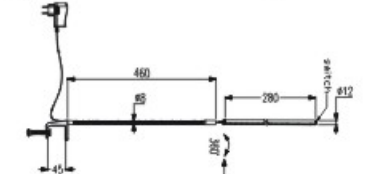
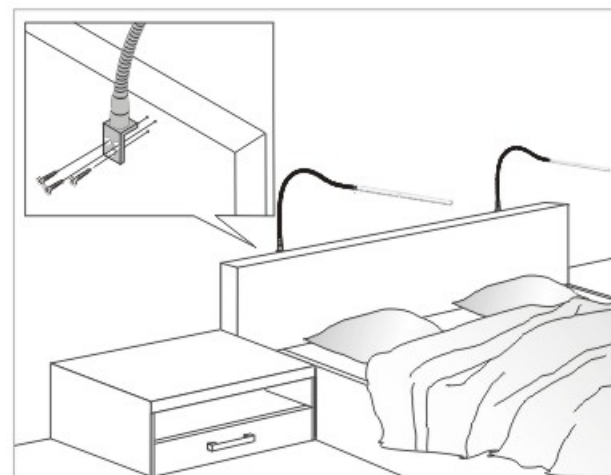

# DRE036

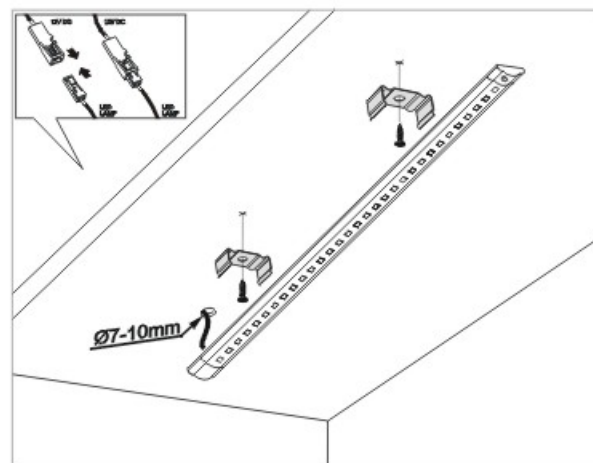

# DRE037

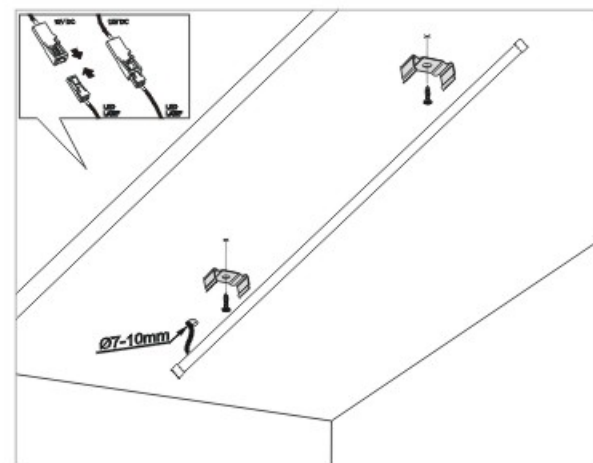

# DRE038

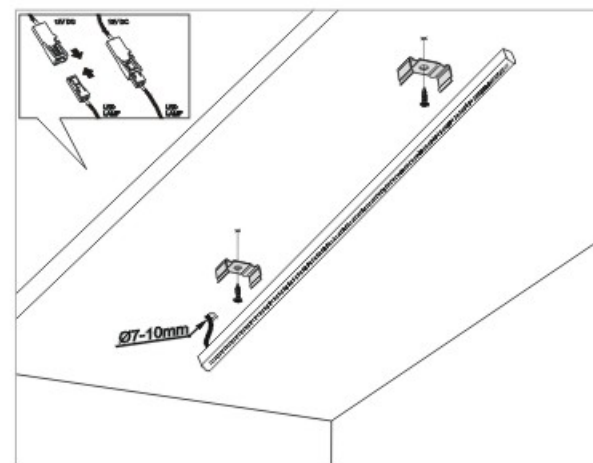

# DRE039

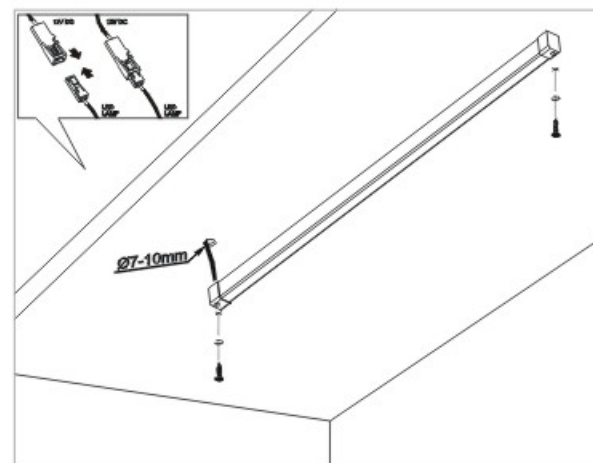



## DRE040

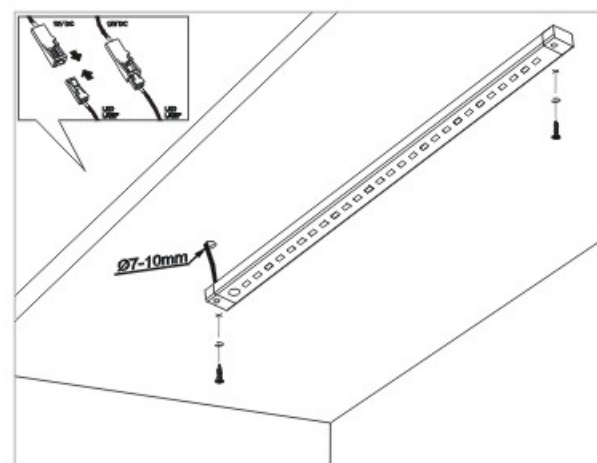
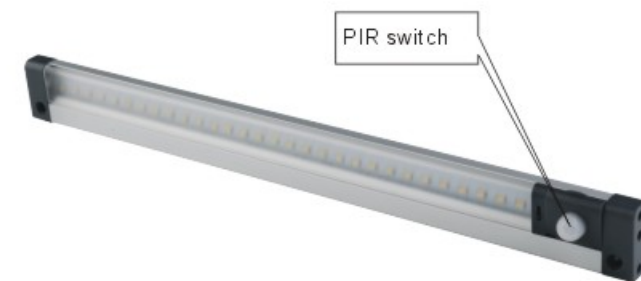

## DRE041

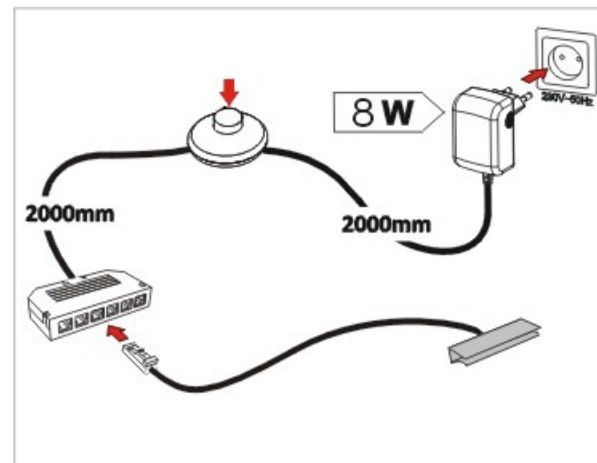

## DRE042

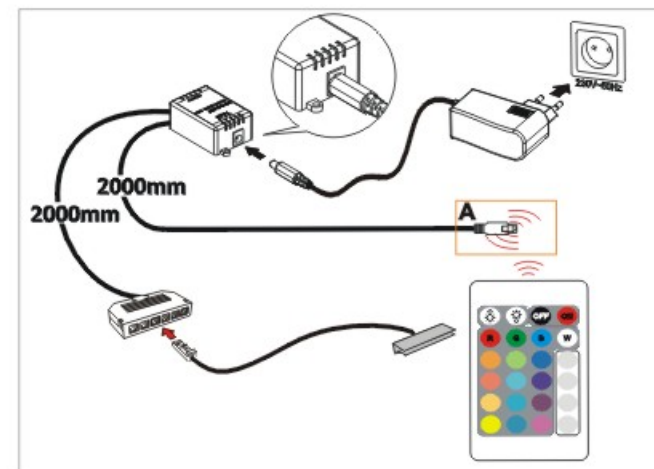

## DRE043-3/6/9



DRE043-3



DRE043-6



DRE043-9

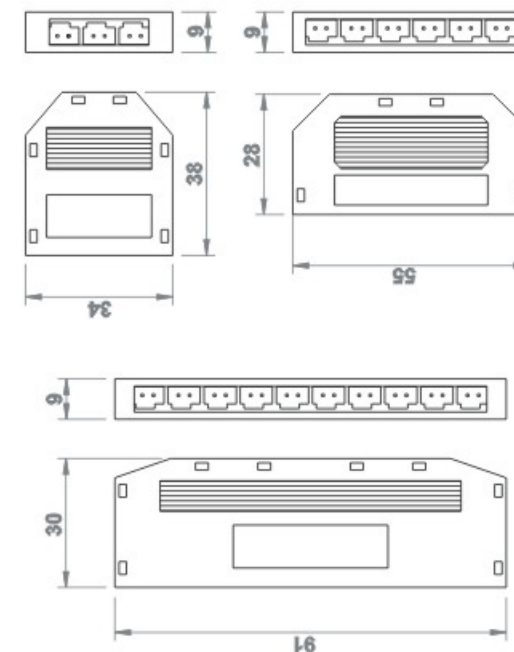

## DRE044-3/6/9



DRE044-3









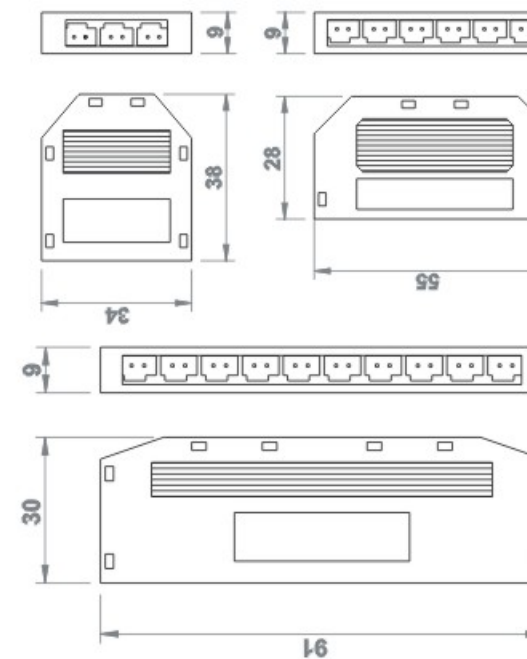

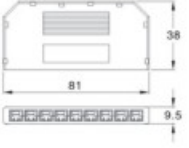



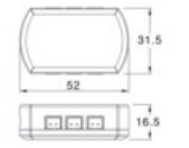

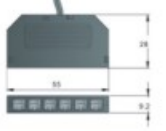

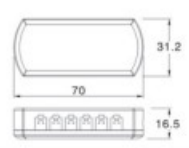

DRE044-6

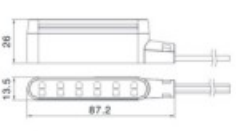

DRE044-9

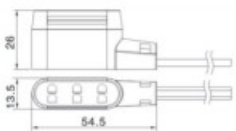

	<p>MODEL:DRE-DC006-1  Nine way distributor  Cable:H03VVH2-F 2*0.5mm<sup>2</sup>  Housing material:PC UL94V0  Conductor:phosphor bronze  Rated voltage:max700mA  Colour:black &amp; white  Rated current:2A</p>			<p>MODEL:DRE-DC001  LED Connector  The diameter of cable:24AWG-22AWG*2  Housing material:PA66/UL94V0  Conductor:phosphor bronze  Rated voltage:max24V  Length:0.1-5M  Rated current:2A</p>	
	<p>MODEL:DRE-DC007  Three/six way distributor  Cable:H03VVH2-F 2*0.5mm<sup>2</sup> or 0.75mm<sup>2</sup>  Housing material:PC UL94V0  Conductor:phosphor bronze  Rated voltage:max24V  Colour:black &amp; white  Rated current:2A</p>			<p>MODEL:DRE-DC004-1 0.35A/0.7A  The connector cable with six sockets  Cable:2*0.34mm<sup>2</sup> or H03VVH2-F 2*0.5mm<sup>2</sup>  Housing material:PC/UL 94V0  Conductor:phosphor bronze  Rated voltage:max700mA  Rated current:2A</p>	
	<p>MODEL:DRE-DC009  Six/twelve way distributor  Cable:H03VV2H-F 2*0.5mm<sup>2</sup> or 2*0.75mm<sup>2</sup>  Housing material:PC UL94V0  Conductor:phosphor bronze  Rated voltage:max24V  Colour:black &amp; white  Rated current:2A</p>			<p>MODEL:DRE-AC005  The connector cable with four sockets low voltage  The cable code:UI2468#  The diameter of cable:24AWG-22AWG*4  Housing material:PC UL 94V0  Conductor:phosphor bronze  Rated voltage:max24V  Rated current:2A  Colour:black&amp;white</p>	
	<p>MODEL:DRE-AC007  Six way distributor  Cable:H03VV2H-F 2*0.5mm<sup>2</sup> or 2*0.75mm<sup>2</sup>  Housing material:PC UL94V0  Conductor:phosphor bronze  Colour:black &amp; white  Rated current:max6A</p>			<p>MODEL:DRE-AC006  The connector cable with low voltage  The cable code: UI2468#  The diameter of cable:24AWG-22AWG*4  Housing material:PA66UL 94V0  Conductor:phosphor bronze  Rated voltage:max24V  Rated current:2A  Colour:black&amp;white</p>	
	<p>MODEL:DRE-AC008  Three way distributor  Cable:H03VV2H-F 2*0.5mm<sup>2</sup> or 2*0.75mm<sup>2</sup>  Housing material:PC UL94V0  Conductor:phosphor bronze  Colour:black &amp; white  Rated current:max6A</p>			<p>MODEL:DRE-AC002  The connector cable with five sockets low voltage  The cable code:UI2468#  The diameter of cable:24AWG-22AWG*2  Housing material:PC UL 94V0  Conductor:phosphor bronze  Rated voltage:max24V  Rated current:2A  Colour:black&amp;white</p>	